

Labels to Love Santa Pouch

Marisa Alvarez

847 922-6795 call/text

marisa@kitchentablestamper.com

marisaalvarez.stampinup.net



Measurements:

All Is Bright Designer Series Paper - 6 1/2 x 4" score at 2 1/8" and 5 1/8" about 1/2" down and stop, do not score all the way down. Punch with 2" Circle and tape according to the diagram

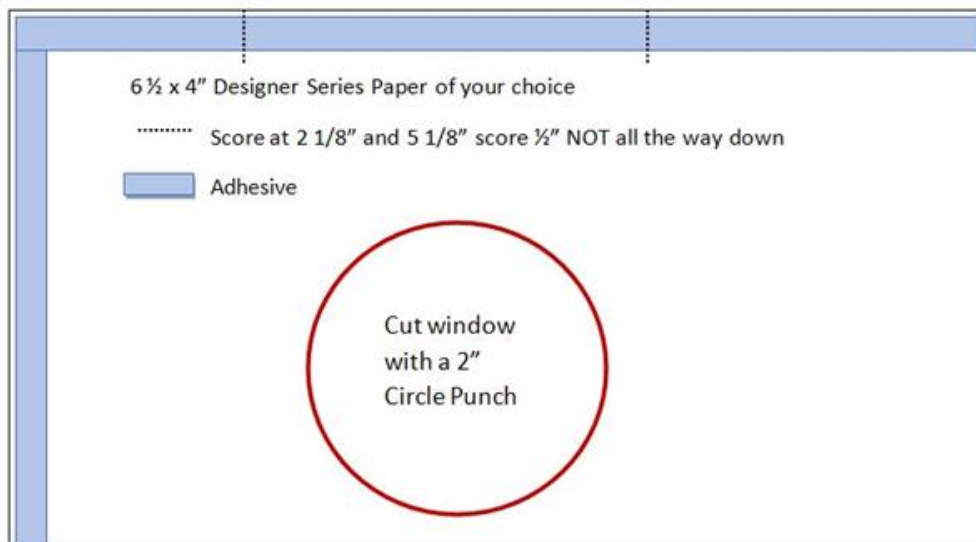

Labels to Love Santa Pouch

Marisa Alvarez
847 922-6795 call/text
marisa@kitchentablestamper.com
marisaalvarez.stampinup.net

Whisper White - 2 1/2 x 3 1/2"

Real Red - 1/2 x 3" for punching or die cutting a heart

Shaded Spruce - 3/4 x 4" for punching two holly leaves with Holly Berry Builder Punch

- [Labels To Love Clear-Mount Stamp Set - 144967](#)
- [Everyday Label Punch - 144668](#)
- [Holly Berry Builder Punch - 141843](#)
- [2" \(5.1 Cm\) Circle Punch - 133782](#)
- [Simply Scored - 122334](#)
- [All Is Bright 12" X 12" \(30.5 X 30.5 Cm\) Designer Series Paper - 147892](#)
- [Santa's Workshop 12" X 12" \(30.5 X 30.5 Cm\) Specialty Designer Series Paper - 147809](#)
- [Dashing Along Designer Series Paper - 149903](#)
- [Shaded Spruce 8-1/2" X 11" Cardstock - 146981](#)
- [Real Red 8-1/2" X 11" Cardstock - 102482](#)
- [Whisper White 8-1/2" X 11" Cardstock - 100730](#)
- [Garden Green 8-1/2" X 11" Cardstock - 102584](#)
- [Poppy Parade 8-1/2" X 11" Cardstock - 119793](#)
- [Real Red Classic Stampin' Pad - 147084](#)
- [Garden Green Classic Stampin' Pad - 126973](#)
- [Shaded Spruce Classic Stampin' Pad - 147088](#)
- [Stampin' Dimensionals - 104430](#)
- [Tear & Tape Adhesive - 138995](#)
- [Multipurpose Liquid Glue - 110755](#)
- [Take Your Pick - 144107](#)